

Rev:A00

Room temperature

SMA Adapter



The RF adapter is a kind of electronic components, also known as RF connectors, used to form the transmission of electronic and RF signals between devices and devices, components and components, systems and subsystems, so as to constitute the basic elements necessary for a complete system, and it also plays an important transmission role in microwave circuits.

Technical requirements

Item	Specification
Model	See datasheet
Impedance	50Ω
Frequency range	DC-18GHz
Return loss	≥20 dB
Insertion loss	≤0.5dB
Temperature	300K
Connector	SMA-M&SMA-F

Material and surface

Item	Material	Surface
Outer conductor	Stainless steel	Passivated finish
Center conductor	Beryllium bronze	Gold plated
Dielectric	PTFE	/

Room temperature SMA Adapter

Test results (ADPG01811A087)

Measure data, $T_{amb}=300K$

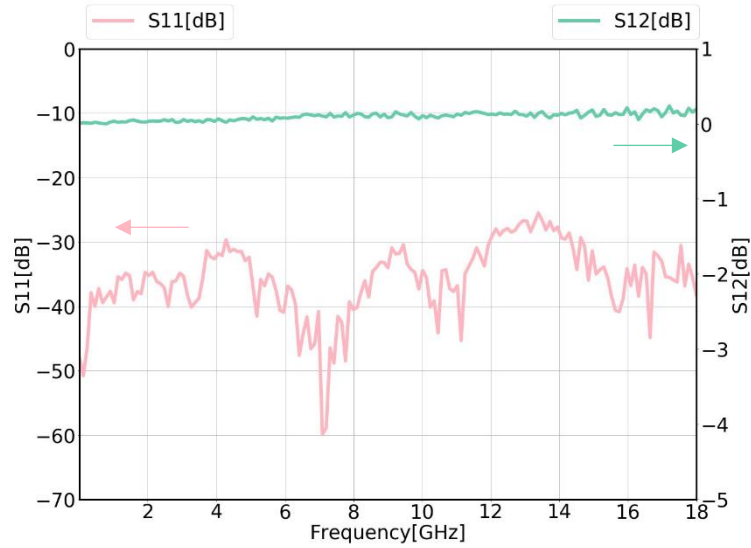

Outline drawing (Unmarked tolerance: $\pm 0.1mm$)

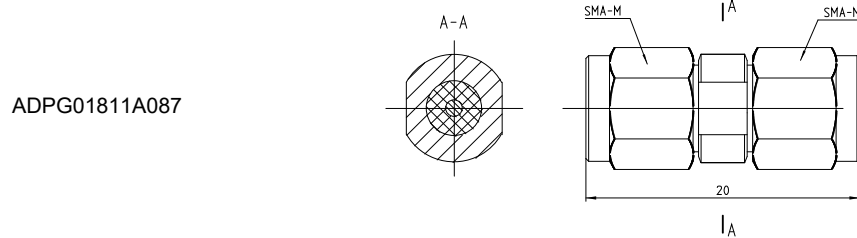

Datasheet

Model	Port 1	Port 2
ADPG01811A036	SMA-M	SMA-F
ADPG01811A049	SMA-F	SMA-F
ADPG01811A087	SMA-M	SMA-M
ADPG01811A107	SMA-F	SMA-F